

MIG/MAG welding torches "ABIMIG® A T LW"

Air cooled • rating 180 A up to 240 A

The newly developed, super lightweight MIG/MAG welding torch series "ABIMIG® A T LW" with ergonomic and universal two-component handle offer flexibility in perfection. They are equipped standard with ball joint and lightweight "Bikox® LW" cable assembly as well as exchangeable and 360° rotatable torch neck, so the torches enable ergonomic and relaxed welding in every position.

- New welding torch series and lightweight "Bikox® LW" cable assembly – Reduction of the torch weight up to 50%
- Newly designed ergonomic handle, optionally available with Up/Down module – Improved working comfort
- Universal contact tip holder (contact tip holder, gas diffuser and gas nozzle holder all in one) – Reduction of the number of spare parts and thus the costs
- Screwable, thermally insulated gas nozzle – Longer service life of the torch and cost reduction
- Turnable, quick-change torch neck – increased working comfort and reduction of service costs



Super lightweight torches with turnable and changeable torch neck

ABIMIG® A T 155 LW

Technical data (EN 60 974-7):

Rating: 190 A CO₂
180 A mixed gas M21 (DIN EN ISO 14175)
Duty cycle: 60%
Wire size: 0.8-1.0 mm

ABIMIG® A T 255 LW

Technical data (EN 60 974-7):

Rating: 240 A CO₂
220 A mixed gas M21 (DIN EN ISO 14175)
Duty cycle: 60%
Wire size: 0.8-1.2 mm

Torch complete Type	Handle	Part-No.			Swan neck	
		3 m	4 m	5 m	Type	Part-No.
ABIMIG® A T 155 LW	Push-button short	006.D821.1	006.D822.1	006.D823.1	45°	006.D804.1
ABIMIG® A T 155 LW	Push-button long	006.D810.1	006.D811.1	006.D812.1	45°	006.D804.1
ABIMIG® A T 255 LW	Push-button short	004.D880.1	004.D881.1	004.D882.1	45°	004.D831.1
ABIMIG® A T 255 LW	Push-button long	004.D850.1	004.D851.1	004.D852.1	45°	004.D831.1

Definition: T = turnable/exchangeable torch neck, LW = lightweight cable assembly

Attention: The specified variants correspond to the "BASIC" version. Further versions (COMBI, VARIO, FREE STYLE) on request.

ABIMIG® A T 155 LW, ABIMIG® A T 255 LW

Wear parts

ABIMIG® A T 155 LW

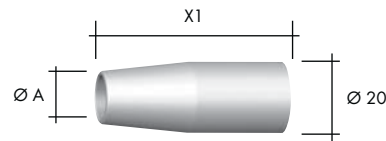

ABIMIG® A T 255 LW

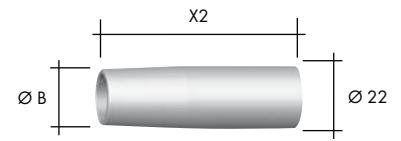

Gas nozzle (5 pcs.)

	Ø A	X1		Ø B	X2	
Cylindrical	Ø 17	52 mm	145.D003	Ø 18	69 mm	145.D014
Conical	Ø 12	52 mm	145.D001 ¹	Ø 16	70 mm	145.D011 ²
Conical	Ø 12	54 mm	145.D004	Ø 14	67 mm	145.D012

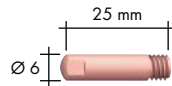

M6



M6

Contact tip (10 pcs.)

E-Cu	Ø 0.8	140.0059 ¹	140.0051
	Ø 1.0	140.0253	140.0242 ²
	Ø 1.2	-	140.0379
E-Cu for Al	Ø 0.8	141.0002	141.0001
	Ø 1.0	141.0007	141.0006
	Ø 1.2	-	141.0010
CuCrZr	Ø 0.8	140.0062	140.0054
	Ø 1.0	140.0256	140.0245
	Ø 1.2	-	140.0382

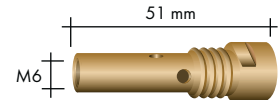
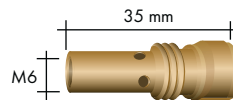

Contact tip holder (5 pcs.)

	006.D719.5 ¹	004.D624.5 ²
--	-------------------------	-------------------------

Adapter piece (5 pcs.)



	767.D607.5 ¹	767.D637.5 ²
--	-------------------------	-------------------------

Torch neck liner for T-torches



Standard	Ø 0.8	122.D037 ¹ (5 pcs.)	122.D037 (5 pcs.)
	Ø 1.0	122.D038 (5 pcs.)	122.D038 ² (5 pcs.)
	Ø 1.2	-	122.D038 (5 pcs.)
Brass for Al	Ø 0.8	122.D040	122.D040
	Ø 1.0	122.D040	122.D041
	Ø 1.2	-	122.D041

Liner		for 3 m	for 4 m	for 5 m
Liner	Ø 0.8	124.0011 ¹	124.0012 ¹	124.0015 ¹
	Ø 1.0	124.0026 ²	124.0031 ²	124.0035 ²
	Ø 1.2	124.0026	124.0031	124.0035
PTFE liner	Ø 0.8	126.0005	126.0008	126.0011
	Ø 1.0	126.0021	126.0026	126.0028
	Ø 1.2	126.0021	126.0026	126.0028
Carbon	Ø 0.8	127.0002	127.0003	127.0004
	Ø 1.0	127.0005	127.0007	127.0008
PTFE liner	Ø 1.0	127.0005	127.0007	127.0008
	Ø 1.2	127.0005	127.0007	127.0008

¹ Included in the standard equipment for complete torches ABIMIG® A T 155 LW.

² Included in the standard equipment for complete torches ABIMIG® A T 255 LW.

MIG/MAG Welding Torches ABIMIG® A T 155 LW

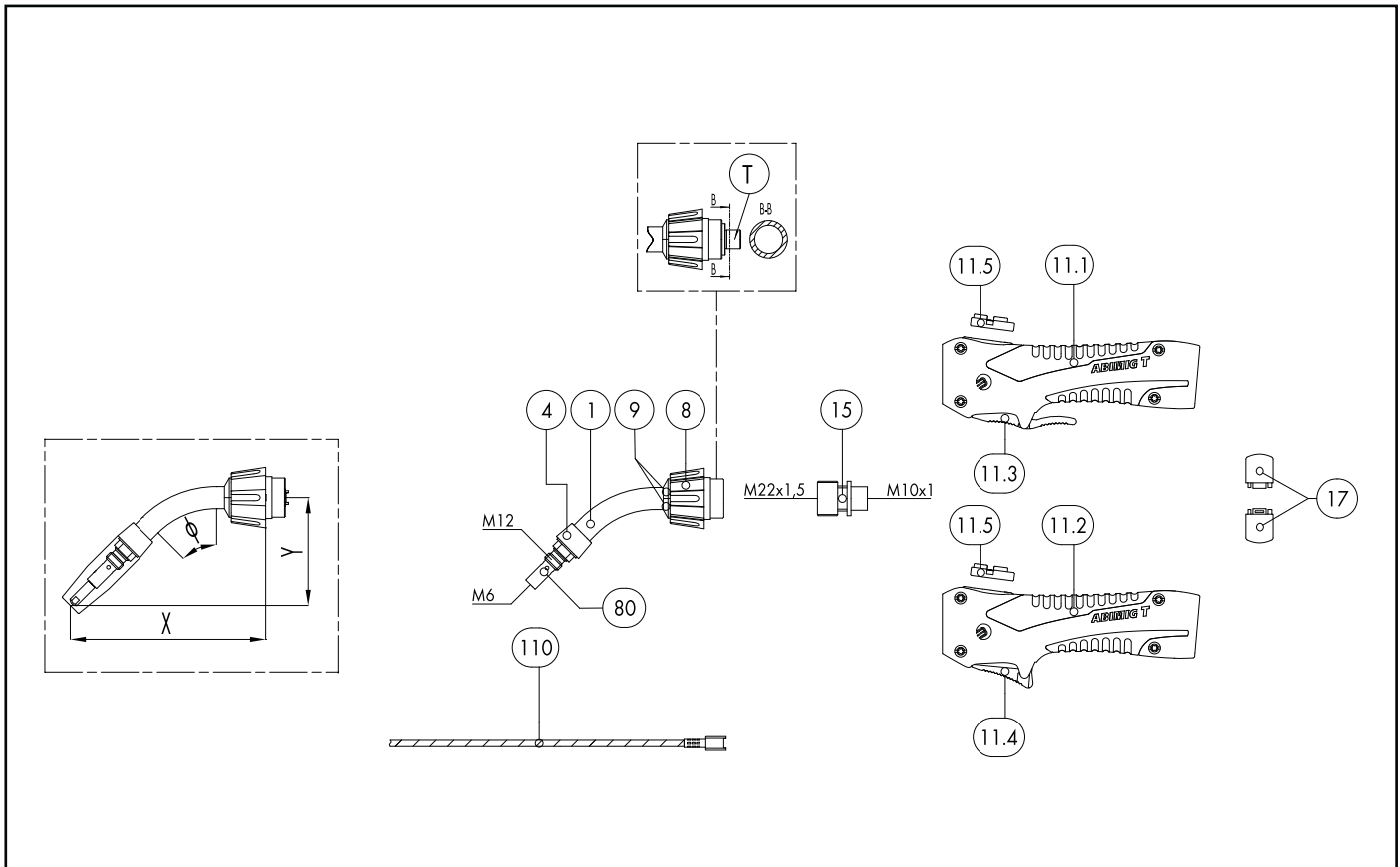

Pos.	Description	Units	Part-No.	Product-group
	Basic torch (complete)			
	ABIMIG® A T 155 LW; T45j; central adaptor KZ-2; 3.00 m		006.D810.1	1323
	ABIMIG® A T 155 LW; T45j; central adaptor KZ-2; 4.00 m		006.D811.1	1323
	ABIMIG® A T 155 LW; T45j; central adaptor KZ-2; 5.00 m		006.D812.1	1323
	Combi torch (basic torch without neck and wear parts)			
			006.D841.1	1325
			006.D842.1	1325
			006.D843.1	1325
	Swan neck			
1	Swan neck ABIMIG® A 155 LW; 45j bent		006.D804.1	1306
1			006.D848.1	1306
1			006.D802.1	1306
1			006.0131.1	1306
1			006.0132.1	1306
1			006.0133.1	1306
4	Spacer	5 Pcs.	767.D607.5	1595
8			014.H279.1	1595
9		10 Pcs.	014.H281.10	1595
	Handle			
11.1	Handle ABIMIG® A T with push-button long		180.D077.1	1595
11.1	Handle ABIMIG® A T with push-button long (without module BIS-52)		180.D079.1	1595
11.2	Handle ABIMIG® A T with push-button short		180.D078.1	1595
11.2	Handle ABIMIG® A T with push-button short (without module BIS-52)		180.D080.1	1595
11.3			185.D118.1	1595
11.4			185.D120.1	1595
11.5			400.D573.1	1595

MIG/MAG Welding Torches ABIMIG® A T 155 LW

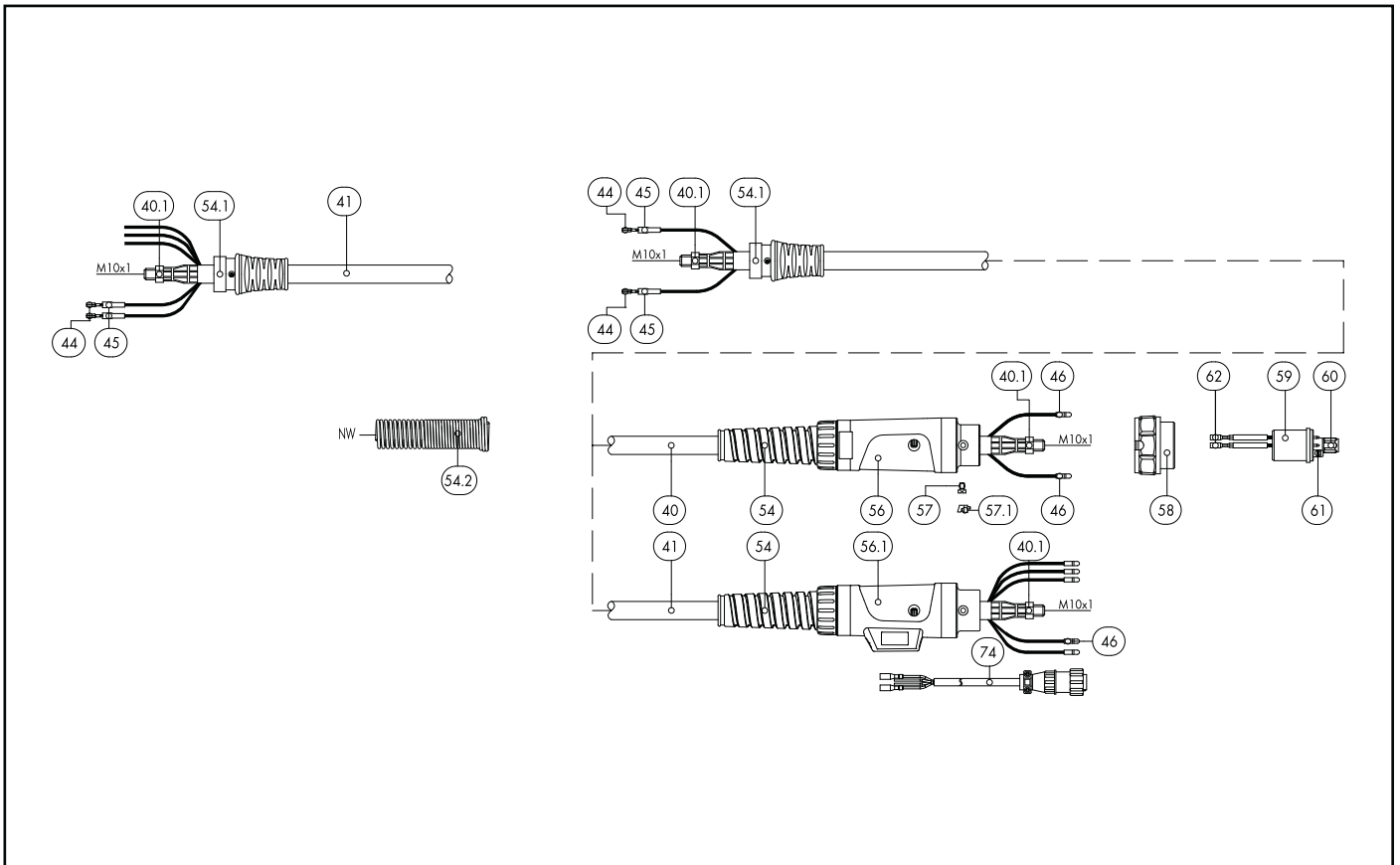

Pos.	Description	Units	Part-No.	Product-group
15			014.H354.1	1595
17	Half rings (1 pair)	2 Pcs.	400.D561.2	1595
	Cable assembly			
40	Bikox® LW-power cable, R4 for 3.00 m		160.H025.1	1511
40	Bikox® LW-power cable, R4 for 4.00 m		160.H026.1	1511
40			160.H380.1	1511
40	Bikox® LW-power cable, R4 for 5.00 m		160.H027.1	1511
40			160.H430.1	1511
40			160.H365.1	1511
40			160.H366.1	1511
40			160.H431.1	1511
40			160.H367.1	1511
40			160.H432.1	1511
40.1	Hexagon nut M10x1	10 Pcs.	001.0009	9010
44	Trigger wire connector	20 Pcs.	175.0022	9010
45	Insulating sleeve	20 Pcs.	400.0119	1095
46	Plug	20 Pcs.	175.0004	9010
54	Cable support ND 19		400.1010	1095
54.1	Cable support spring ND 21		400.D205	1595
54.1	Cable support ABIMIG® A T LW (short)		400.D574.1	1595
56	Cable support machine side		501.2248	9010
56.1			501.D578.1	1595
57	Pan head screw M4x6	20 Pcs.	000.0552	9010
57.1	Screw cap 1	20 Pcs.	500.0251	9010
58	Adaptor nut M33x2		500.0213	9010
59	Central adaptor KZ-2		501.0003	1095

MIG/MAG Welding Torches ABIMIG® A T 155 LW

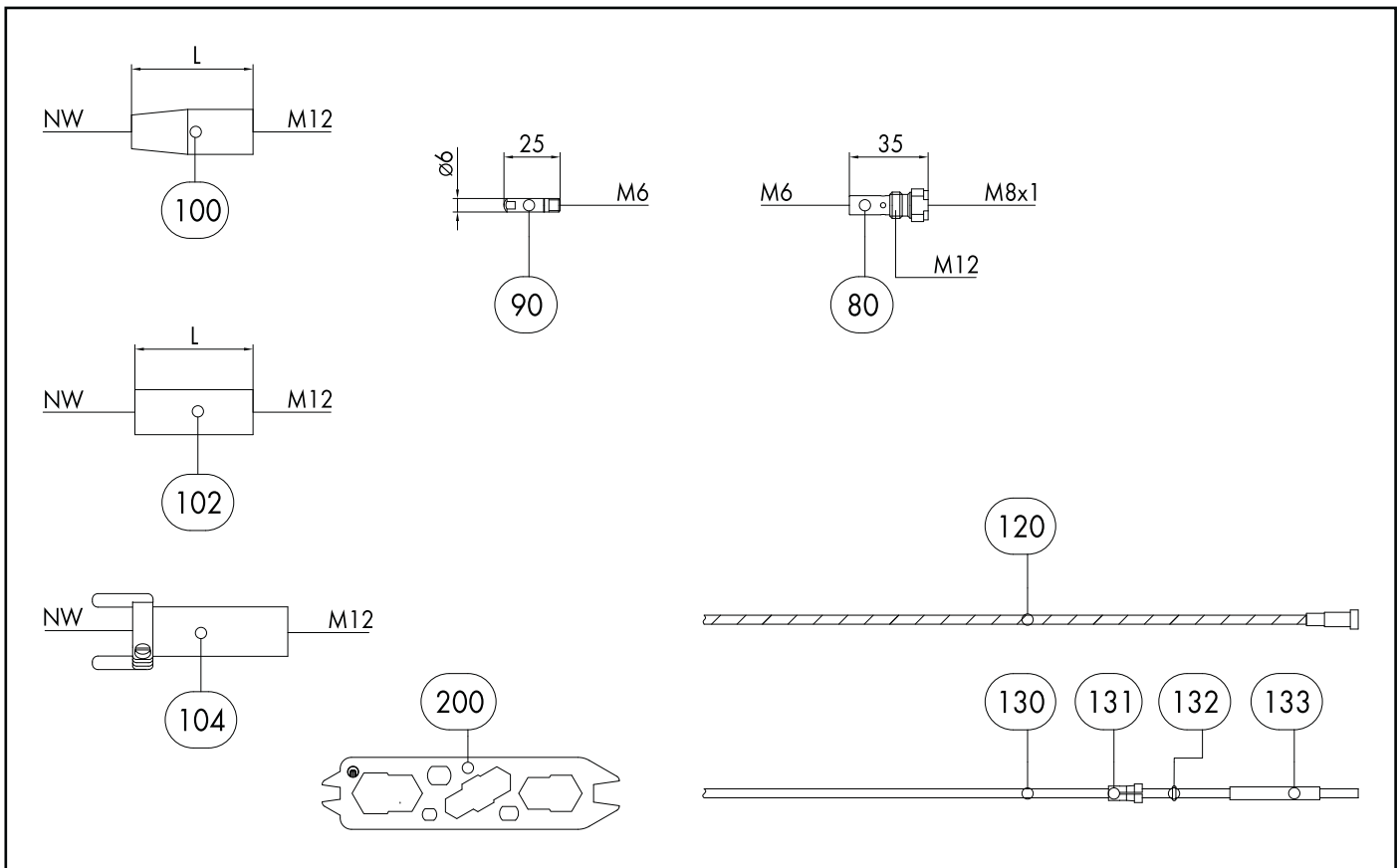

Pos. Description

Pos.	Description	Units	Part-No.	Product-group
60	Coupling nut M10x1, plastic	5 Pcs.	501.D536.5	1595
61	O-Ring 4x1	20 Pcs.	165.0002	9010
62	Trigger wire connector; female	20 Pcs.	175.0003	9010
74			175.D098	1595
74.1			110.D023	1595
	Wear parts			
80	Contact tip holder M12/M6/35 US	5 Pcs.	006.D719.5	1533
90	Contact tip M6 E-Cu; ~ 0.6 (6x25)	10 Pcs.	140.0008	1030
90	Contact tip M6 E-Cu; ~ 0.8 (6x25)	10 Pcs.	140.0059	1030
90	Contact tip M6 E-Cu; ~ 1.0 (6x25)	10 Pcs.	140.0253	1030
90	Contact tip M6 CuCrZr; ~ 0.6 (6x25)	10 Pcs.	140.0855	1031
90	Contact tip M6 CuCrZr; ~ 0.8 (6x25)	10 Pcs.	140.0062	1031
90	Contact tip M6 CuCrZr; ~ 1.0 (6x25)	10 Pcs.	140.0256	1031
90	Contact tip M6 E-Cu; ~ 0.8 for alu wire (6x25)	10 Pcs.	141.0002	1030
90	Contact tip M6 E-Cu; ~ 1.0 for alu wire (6x25)	10 Pcs.	141.0007	1030
90	Contact tip M6 CuCrZr silver-plated; ~ 0.8 (6x25)	10 Pcs.	147.0062	1031
90	Contact tip M6 CuCrZr silver-plated; ~ 1.0 (6x25)	10 Pcs.	147.0256	1031
100	Gas nozzle M12; ND 12; galvanized; conical L=52 mm	5 Pcs.	145.D001	1536
100		5 Pcs.	145.D002	1536
100		5 Pcs.	145.D006	1536
100	Gas nozzle M12; ND 12; galvanized; conical L=54 mm	5 Pcs.	145.D004	1536
102	Gas nozzle M12; ND 17; galvanized; cylindrical L=52 mm	5 Pcs.	145.D003	1536
102	Gas nozzle M12; ND 12 blank; conical with extended insulation L=52 mm	5 Pcs.	145.D205	1536
104		5 Pcs.	145.D009	1536
110	Neck liner 1.5; for wire ~ 0.6 - 1.0; for ABIMIG® T-Line		122.D037	1534
110	Neck liner 1.6; brass; for wire ~ 0.6 - 1.0; for ABIMIG® T-Line		122.D040	1534

MIG/MAG Welding Torches ABIMIG® A T 255 LW

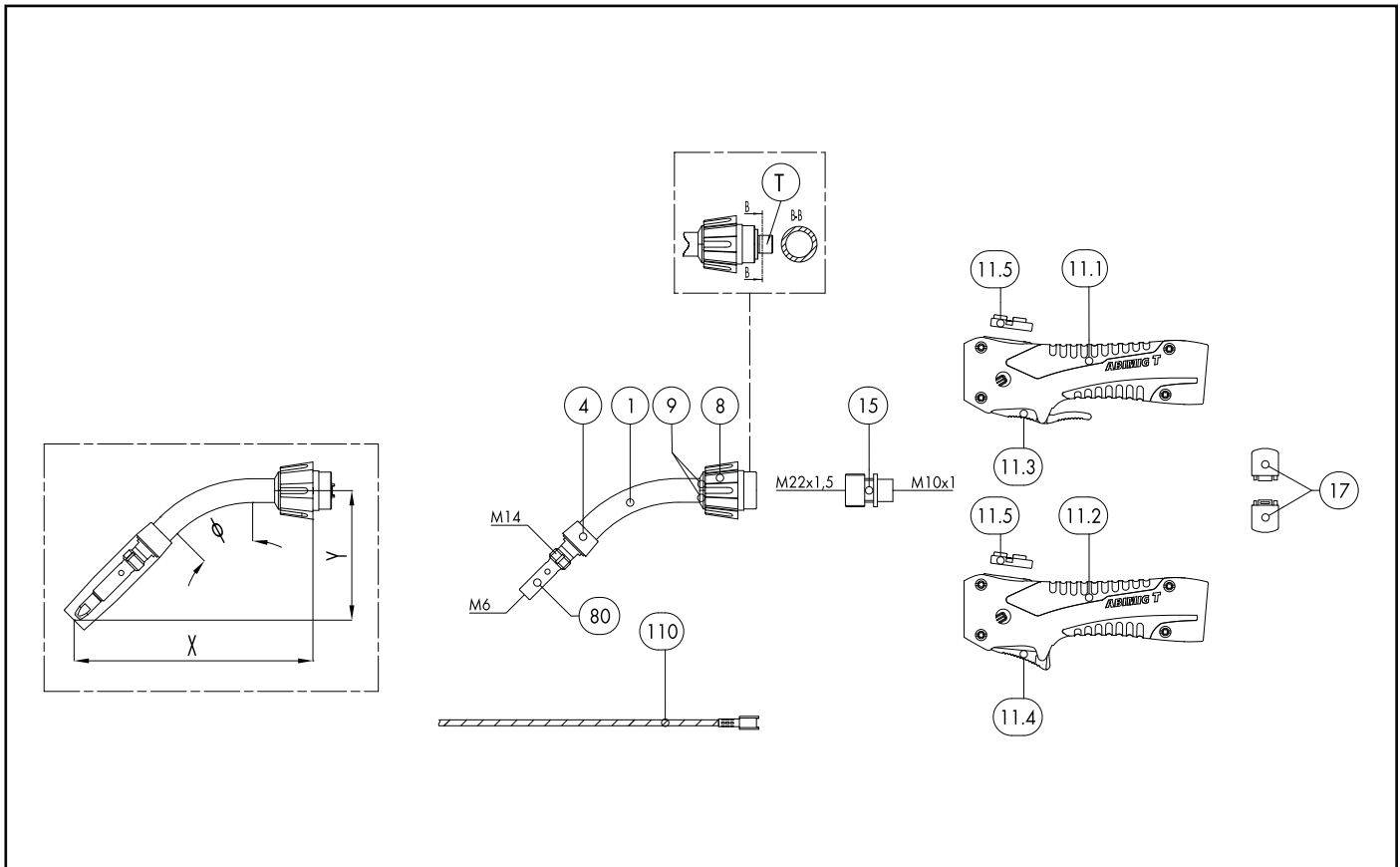

Pos.	Description	Units	Part-No.	Product-group
	Basic torch (complete)			
	ABIMIG® A T 255 LW; T45j; central adaptor KZ-2; 3.00 m		004.D850.1	1323
	ABIMIG® A T 255 LW; T45j; central adaptor KZ-2; 4.00 m		004.D851.1	1323
	ABIMIG® A T 255 LW; T45j; central adaptor KZ-2; 5.00 m		004.D852.1	1323
	Combi torch (basic torch without neck and wear parts)			
			004.D894.1	1325
			004.D895.1	1325
			004.D896.1	1325
	Swan neck			
1			004.D837.1	1306
1	Swan neck ABIMIG® A 255 LW; 45j bent		004.D831.1	1306
1			004.D842.1	1306
1			004.D860.1	1306
1			004.D907.1	1306
1			004.D912.1	1306
1			004.D919.1	1306
1			004.D924.1	1306
			004.D845.1	1306
			004.D846.1	1306
			004.D915.1	1306
			004.D916.1	1306
			004.D917.1	1306
			004.D918.1	1306
			004.D927.1	1306
			004.D928.1	1306
			004.D826.1	1306

MIG/MAG Welding Torches ABIMIG® A T 255 LW

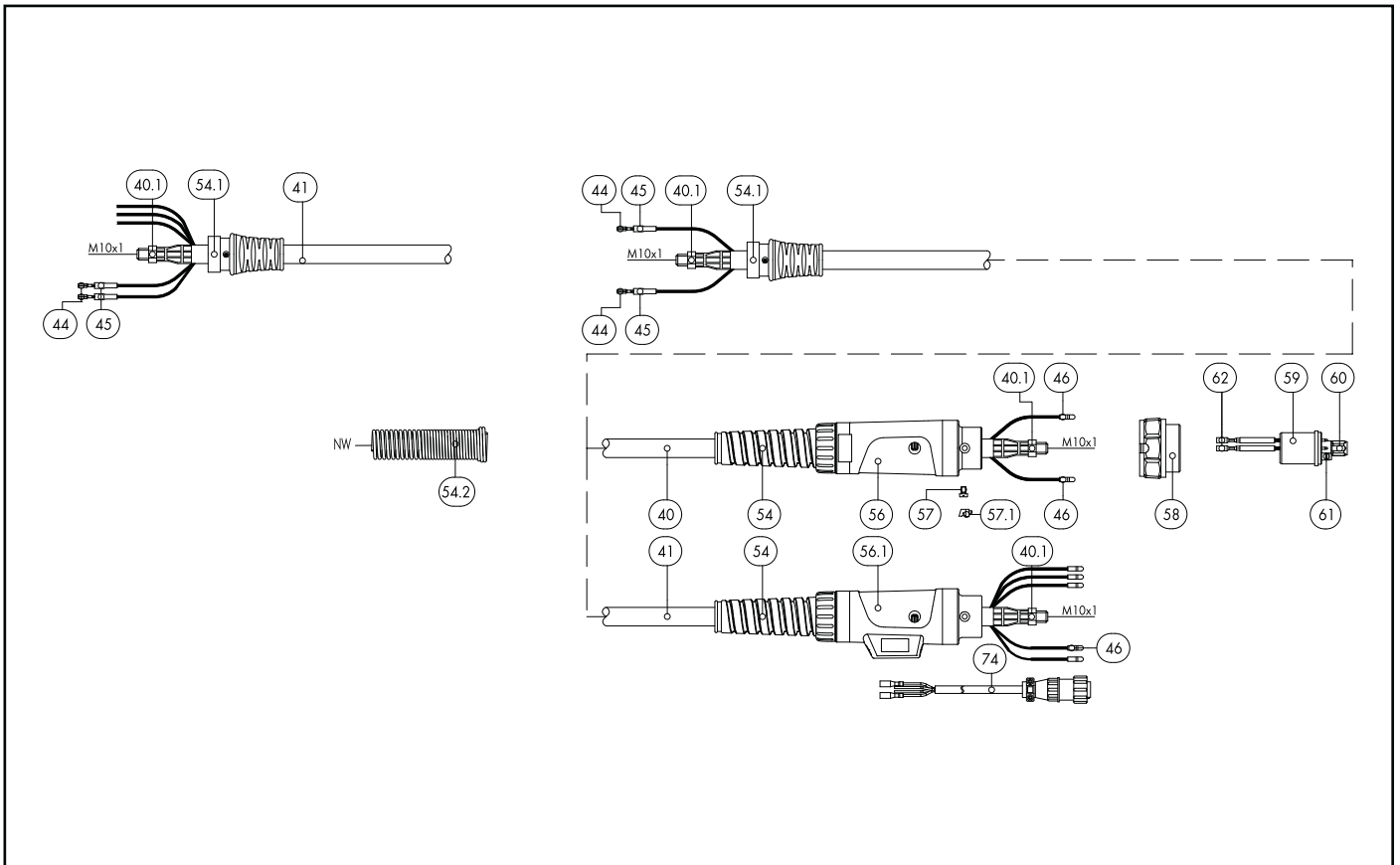

Pos.	Description	Units	Part-No.	Product-group
			004.0638.1	1306
			004.0639.1	1306
			004.0640.1	1306
			004.0641.1	1306
			004.0642.1	1306
			004.0643.1	1306
			004.0644.1	1306
			004.0645.1	1306
			004.0646.1	1306
4	Spacer	5 Pcs.	767.D637.5	1595
8			014.H279.1	1595
9		10 Pcs.	014.H282.10	1595
	Handle			
11.1	Handle ABIMIG® A T with push-button long		180.D077.1	1595
11.1	Handle ABIMIG® A T with push-button long (without module BIS-52)		180.D079.1	1595
11.2	Handle ABIMIG® A T with push-button short		180.D078.1	1595
11.2	Handle ABIMIG® A T with push-button short (without module BIS-52)		180.D080.1	1595
11.3			185.D118.1	1595
11.4			185.D120.1	1595
11.5			400.D573.1	1595
15			014.H354.1	1595
17	Half rings (1 pair)	2 Pcs.	400.D561.2	1595
	Cable assembly			
40	Bikox® LW-power cable, R5 for 3.00 m		160.H032.1	1511
40	Bikox® LW-power cable, R5 for 4.00 m		160.H033.1	1511
40			160.H242.1	1511

MIG/MAG Welding Torches ABIMIG® A T 255 LW

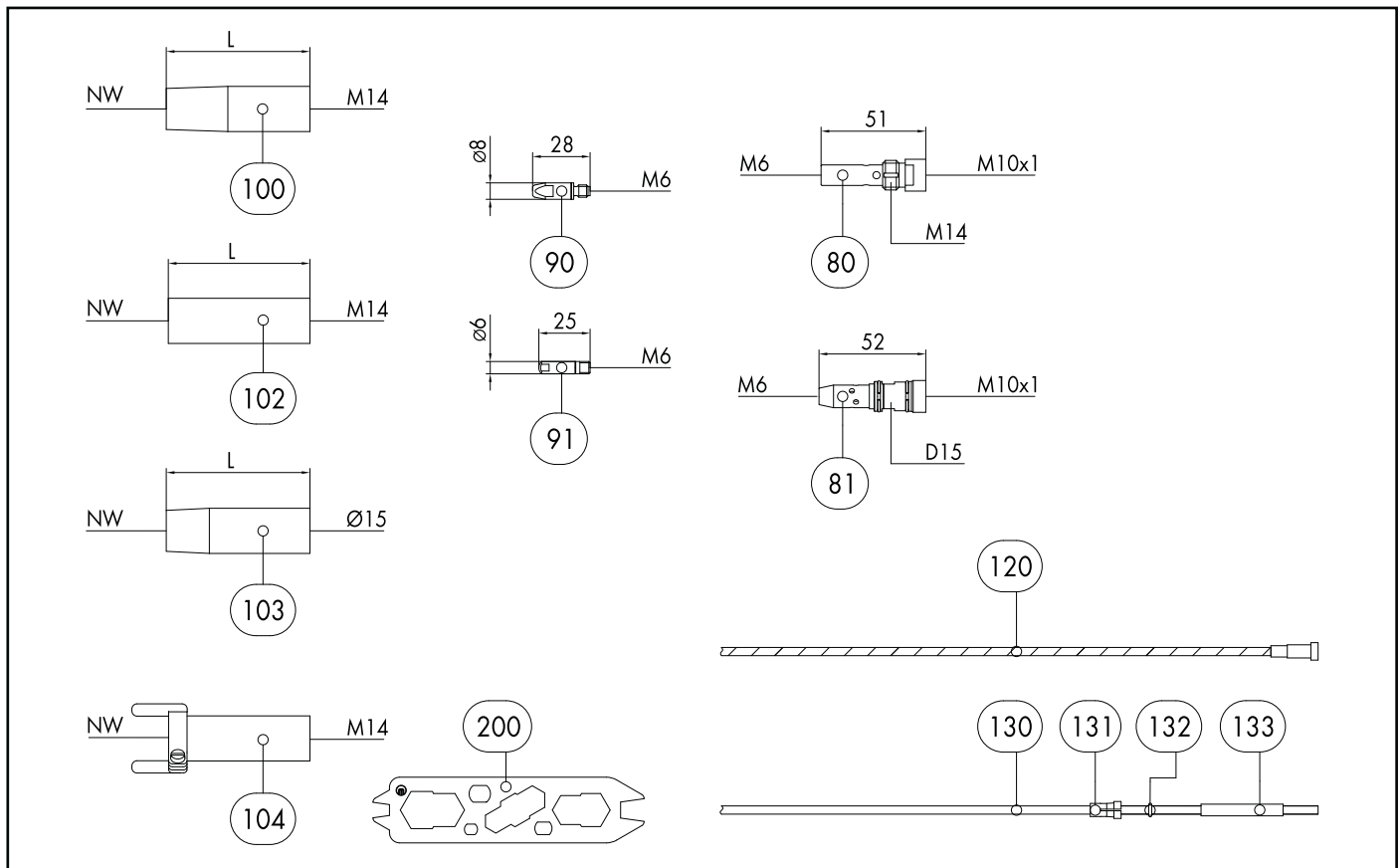

Pos.	Description	Units	Part-No.	Product-group
40	Bikox® LW-power cable, R5 for 5.00 m		160.H034.1	1511
40			160.H433.1	1511
40			160.H368.1	1511
40			160.H369.1	1511
40			160.H434.1	1511
40			160.H370.1	1511
40			160.H435.1	1511
40.1	Hexagon nut M10x1	10 Pcs.	001.0009	9010
44	Trigger wire connector	20 Pcs.	175.0022	9010
45	Insulating sleeve	20 Pcs.	400.0119	1095
46	Plug	20 Pcs.	175.0004	9010
54	Cable support ND 19		400.1010	1095
54.1	Cable support ABIMIG® A T LW (short)		400.D574.1	1595
54.1	Cable support spring ND 21		400.D205	1595
56	Cable support machine side		501.2248	9010
56.1			501.D578.1	1595
57	Pan head screw M4x6	20 Pcs.	000.0552	9010
57.1	Screw cap 1	20 Pcs.	500.0251	9010
58	Adaptor nut M33x2		500.0213	9010
59	Central adaptor KZ-2		501.0003	1095
60	Coupling nut M10x1, plastic	5 Pcs.	501.D536.5	1595
61	O-Ring 4x1	20 Pcs.	165.0002	9010
62	Trigger wire connector; female	20 Pcs.	175.0003	9010
74			175.D098	1595
	Wear parts			
80	Contact tip holder M14/M6/51 US	5 Pcs.	004.D624.5	1533

MIG/MAG Welding Torches ABIMIG® A T 255 LW

Pos.	Description	Units	Part-No.	Product-group
81	Contact tip holder D15/M8/53 for slip-on gas nozzle	5 Pcs.	004.D763.5	1533
90	Contact tip M6 E-Cu; $\bar{\text{~}}$ 0.8 (8x28)	10 Pcs.	140.0051	1030
90	Contact tip M6 E-Cu; $\bar{\text{~}}$ 1.0 (8x28)	10 Pcs.	140.0242	1030
90	Contact tip M6 E-Cu; $\bar{\text{~}}$ 1.2 (8x28)	10 Pcs.	140.0379	1030
90	Contact tip M6 CuCrZr; $\bar{\text{~}}$ 0.8 (8x28)	10 Pcs.	140.0054	1031
90	Contact tip M6 CuCrZr; $\bar{\text{~}}$ 1.0 (8x28)	10 Pcs.	140.0245	1031
90	Contact tip M6 CuCrZr; $\bar{\text{~}}$ 1.2 (8x28)	10 Pcs.	140.0382	1031
90	Contact tip M6 E-Cu; $\bar{\text{~}}$ 0.8 for alu wire (8x28)	10 Pcs.	141.0001	1030
90	Contact tip M6 E-Cu; $\bar{\text{~}}$ 1.0 for alu wire (8x28)	10 Pcs.	141.0006	1030
90	Contact tip M6 E-Cu; $\bar{\text{~}}$ 1.2 for alu wire (8x28)	10 Pcs.	141.0010	1030
90	Contact tip M6 CuCrZr silver-plated; $\bar{\text{~}}$ 0.8 (8x28)	10 Pcs.	147.0054	1031
90	Contact tip M6 CuCrZr silver-plated; $\bar{\text{~}}$ 1.0 (8x28)	10 Pcs.	147.0245	1031
90	Contact tip M6 CuCrZr silver-plated; $\bar{\text{~}}$ 1.2 (8x28)	10 Pcs.	147.0382	1031
90		10 Pcs.	147.5172.10	5038
90		10 Pcs.	147.5245	5038
90		10 Pcs.	147.5382	5038
91	Contact tip M6 E-Cu; $\bar{\text{~}}$ 0.8 (6x25)	10 Pcs.	140.0059	1030
91	Contact tip M6 E-Cu; $\bar{\text{~}}$ 1.0 (6x25)	10 Pcs.	140.0253	1030
91		10 Pcs.	140.0387	1030
91	Contact tip M6 CuCrZr; $\bar{\text{~}}$ 0.8 (6x25)	10 Pcs.	140.0062	1031
91	Contact tip M6 CuCrZr; $\bar{\text{~}}$ 1.0 (6x25)	10 Pcs.	140.0256	1031
91		10 Pcs.	140.0390	1031
91	Contact tip M6 E-Cu; $\bar{\text{~}}$ 0.8 for alu wire (6x25)	10 Pcs.	141.0002	1030
91	Contact tip M6 E-Cu; $\bar{\text{~}}$ 1.0 for alu wire (6x25)	10 Pcs.	141.0007	1030
91		10 Pcs.	141.0011	1030
91	Contact tip M6 CuCrZr silver-plated; $\bar{\text{~}}$ 0.8 (6x25)	10 Pcs.	147.0062	1031
91	Contact tip M6 CuCrZr silver-plated; $\bar{\text{~}}$ 1.0 (6x25)	10 Pcs.	147.0256	1031
91	Contact tip M6 CuCrZr silver-plated; $\bar{\text{~}}$ 1.2 (6x25)	10 Pcs.	147.0390	1031
100	Gas nozzle M14; ND 16; galvanized	5 Pcs.	145.D011	1536
	Gas nozzle M14; ND 14; galvanized; conical L=67 mm	5 Pcs.	145.D012	1536
		5 Pcs.	145.D013	1536
	Gas nozzle M14; ND 16 blank; with extended insulation	5 Pcs.	145.D195	1536
		5 Pcs.	145.D268	1537
	Gas nozzle M14; ND 14; galvanized; conical L=67 mm	5 Pcs.	145.D012	1536
		5 Pcs.	145.D190	1536
		5 Pcs.	145.D016	1536
		5 Pcs.	145.D015	1536
102	Gas nozzle M14; ND 18 galvanized; cylindrical L=67 mm	5 Pcs.	145.D014	1536
103	Gas nozzle (slip-on) D15; ND 16 galvanized	5 Pcs.	145.D375.5	1537
		5 Pcs.	145.D452.5	1537
		5 Pcs.	145.D451.5	1537
104		5 Pcs.	145.D019	1536
110	Neck liner 1.5; for wire $\bar{\text{~}}$ 0.6 - 1.0; for ABIMIG® T-Line		122.D037	1534
110	Neck liner 2.0; for wire $\bar{\text{~}}$ 1.0 - 1.2; for ABIMIG® T-Line		122.D038	1534
110	Neck liner 1.6; brass; for wire $\bar{\text{~}}$ 0.6 - 1.0; for ABIMIG® T-Line		122.D040	1534
110	Neck liner 2.2; brass; for wire $\bar{\text{~}}$ 1.0 - 1.4; for ABIMIG® T-Line		122.D041	1534
120	Guide spiral liner insulated; 1.5/4.5; blue; for wire $\bar{\text{~}}$ 0.6 - 0.8; for 3.00 m		124.0011	1034
120	Guide spiral liner insulated; 1.5/4.5; blue; for wire $\bar{\text{~}}$ 0.6 - 0.8; for 4.00 m		124.0012	1034
120	Guide spiral liner insulated; 1.5/4.5; blue; for wire $\bar{\text{~}}$ 0.6 - 0.8; for 5.00 m		124.0015	1034
120			124.0016	1034

